



Bearings reference a record bearing of N59°10'00"E on the South line of Beloit Street along the Northerly line of Block 26 of the Fourth Addition to Darien, which produces a bearing of N0°09'00"W on the East line of the Southwest 1/4 of Section 27. Said East line recorded as N1°34'02"W in the Wisconsin State Plane Coordinate System, South Zone.

Coordinates are referenced to the Wisconsin State Plane Coordinate System, South Zone, (NAD-27).

# Plat of Survey

of

## Tax Parcels QVD 00066 & QVD 00067,

located in the Southeast 1/4 of the Southwest 1/4 of Section 27, Town 2 North, Range 15 East, Village of Darien, Walworth County, Wisconsin.

### Legal Descriptions

Lands described in a Quit Claim Deed recorded May 20, 2013 as Document No. 863309 as shown below:

PARCEL I: A parcel of land located in the Southwest 1/4 of Section 27, T2N, R15E, Village of Darien, County of Walworth, State of Wisconsin, described as follows, to-wit: Commencing at the intersection of the centerline of the Chicago Madison Road and the centerline of the Milwaukee Beloit Road, thence South 59° West along the centerline or said Milwaukee Beloit Road 396 feet to the place of beginning, thence continue South 59° West along the centerline of said Milwaukee Beloit Road 68 feet; thence South 34° 24' East, 306.75 feet to the point; thence North 57° 37' East, 68 feet to the Hubert McCarthy property; thence North 34° 24' West along said property 305.15 feet to the place of beginning.

PARCEL II: A parcel of land located in the Southwest 1/4 of Section 27, T2N, R15E, Village of Darien, County of Walworth, State of Wisconsin, described as follows, to-wit: Commencing at the intersection of the centerline of the Chicago Madison Road and the centerline of the Milwaukee Beloit Road, thence South 59° West along the centerline of said Milwaukee Beloit Road 396 feet to the place of beginning, thence continue South 34° 24' East, 305.15 feet; thence North 57° 37' East, 66 feet; thence North 34° 24' West, 303.12 feet; thence South 59° West, 66 feet to the place of beginning.

Surveyed for: **Duane Czarnecki**

129 West Beloit Street  
Darien, Wisconsin. 53114

Tax Parcel  
QVD 00065  
Doc. No. 904173

### Tax Parcel QVD 00066

0.460 Acre  
20,026 Sq.Ft.  
0.410 Acre  
17,848 Sq.Ft.  
Exclusive of R.O.W.

### Tax Parcel QVD 00067

0.476 Acre  
20,756 Sq.Ft.  
0.425 Acre  
17,512 Sq.Ft.  
Exclusive of R.O.W.

Tax Parcel  
QVD 00068  
Doc. No. 949638

Tax Parcel  
QVD 00079  
Doc. No. 763695

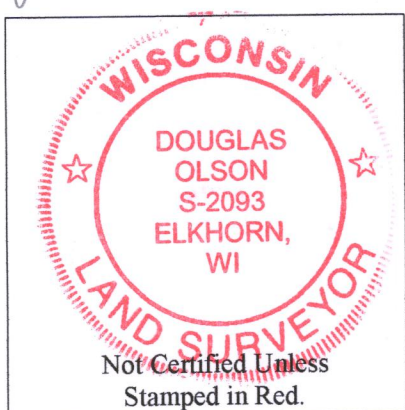
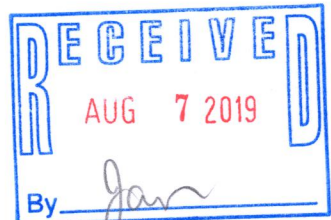

### Notes:

- 1) This Plat of Survey is not certified unless signed and sealed in red ink.
- 2) This survey is subject to Wisconsin lien laws. This Plat of Survey is the notice of intent to file lien. Lien waiver required.
- 3) The Survey Date shown on this Plat of Survey is the completion date of the field work.

Copyright © 2018 by Olson Land Surveying, LLC.

All rights reserved. No part of this survey plat may be reproduced or transmitted in any form by any means - graphic, electronic, or mechanical, including photocopying, tracing, or information storage and retrieval systems - without permission in writing from Douglas G. Olson, Olson Land Surveying, LLC.

I hereby certify that I have surveyed the above described property in compliance with Chapter A-E 7 of the Wisconsin Administrative Code and that the map hereon is correct to the best of my professional knowledge and belief and shows the size and location of the property, its exterior boundaries, the location and dimensions of all visible structures thereon, boundary fences, apparent easements and roadways and visible encroachments, if any.

This survey is made for the exclusive use of the present owners of the property, and also those who purchase, mortgage or guarantee title thereto, within one year from the date hereof.

Douglas G. Olson  
Wisconsin Professional Land Surveyor - 2093

Sheet 1 of 1 Sheets

Drawing Name:

Job Reference Number  
**2018.153**

### Legend of Symbols & Abbreviations

- |                             |              |
|-----------------------------|--------------|
| Found County Section Corner | N North      |
| Found Iron Pipe             | S South      |
| Found Iron Rod              | E East       |
| Set Iron Rod, 1" dia.       | W West       |
| ( ) Recorded Information    | In Bearings  |
| Utility Pole                | Degrees      |
| Utility Pedestal            | Minutes      |
| Catch Basin                 | Seconds      |
| Asphalt Surface             | In Distances |
| Concrete Surface            | Feet         |
|                             | Inches       |
- Fire Hydrant
  - Manhole
  - Gravel Surface
  - Concrete Surface



45 South Wisconsin Street | P.O. Box 322  
Elkhorn, Wisconsin. 53121  
Telephone: (262) 723-3434  
Facsimile: (262) 723-8044  
Email: doug@olsonsurveying.com  
Website: www.olsonsurveying.com

Scale in Feet  
1" = 20'



Survey Date: December 18, 2018.

Revisions:

2018.153

QVD-66 QVD-67 001-617